

19/02/2024 2:52:17 PM \\Autodesk Docs\\CPB\_RPA\\RPA-ARC-JAC-MDL-MM-980106.rvt

# ROYAL PRINCE ALFRED HOSPITAL REDEVELOPMENT CAMPUS INFRASTRUCTURE WORKS REF#5 PACKAGE PROPOSED WESTERN CAMPUS MEDICAL GAS COMPOUND EXPANSION & ASSOCIATED WORKS

ARCHITECTURAL DRAWING LIST - REFS	
Sheet Number	Sheet Name
000000	
RPA-ARC-JAC-DRG-REFS-000000	COVER SHEET - REFS
RPA-ARC-JAC-DRG-REFS-000001	EXISTING OVERALL SITE PLAN - REF 5
RPA-ARC-JAC-DRG-REFS-000002	EXISTING SITE PLAN - WESTERN CAMPUS - REFS
RPA-ARC-JAC-DRG-REFS-000003	PROPOSED LEVEL 1 PLAN - WESTERN CAMPUS - REF 5
RPA-ARC-JAC-DRG-REFS-000004	PROPOSED ROOF PLAN - WESTERN CAMPUS - REFS
180000	
RPA-ARC-JAC-DRG-REFS-180001	DEMOLITION PLAN - WESTERN CAMPUS - REFS
400000	
RPA-ARC-JAC-DRG-REFS-400001	ELEVATIONS - REFS



**DETERMINED – APPROVAL**

REF Approval No: 04/2024

Date: 5/06/2024

Signed by: 

## NOTES

1. DO NOT SCALE DRAWINGS. WRITTEN DIMENSIONS GOVERN.
2. ALL DIMENSIONS ARE IN MILLIMETRES UNLESS NOTED OTHERWISE.
3. ALL DIMENSIONS SHALL BE VERIFIED ON SITE BEFORE PROCEEDING WITH THE WORK. JACOBS SHALL BE NOTIFIED IN WRITING OF ANY DISCREPANCIES.
4. THIS DRAWING MUST BE READ IN CONJUNCTION WITH ALL RELEVANT CONTRACTS, SPECIFICATIONS, REPORTS AND DRAWINGS.
5. ALL DRAWINGS TO BE PRINTED IN COLOUR. DO NOT PHOTOCOPY - PRINT ORIGINAL FROM ELECTRONIC FILE FOR HARD COPY.
6. VARIATIONS TO WORK SHOWN MUST BE BROUGHT TO THE PRINCIPALS ATTENTION AND APPROVED IN WRITING BEFORE PROCEEDING.
7. THIS DRAWING IS COPYRIGHT AND THE PROPERTY OF THE PRINCIPALS AND MUST NOT BE RETAINED, COPIED OR USED WITHOUT THE PERMISSION OF THE AUTHOR.
8. THIS DRAWING IS FOR REF APPLICATION PURPOSES ONLY & IS NOT AUTHORISED FOR USE FOR CONSTRUCTION. ALL DIMENSIONS ARE PRELIMINARY IN NATURE & ARE TO BE VERIFIED ON SITE.

H	19/02/24	ISSUED FOR SSDA
G	18/09/23	REVISED REFS DRAFT ISSUE
F	03/09/23	REFS FINAL ISSUE
E	27/02/23	REFS DRAFT ISSUE
D	18/01/23	REFS DRAFT ISSUE
C	17/01/23	REFS DRAFT ISSUE
B	18/12/22	REFS DRAFT ISSUE
A	16/12/22	REFS DRAFT ISSUE

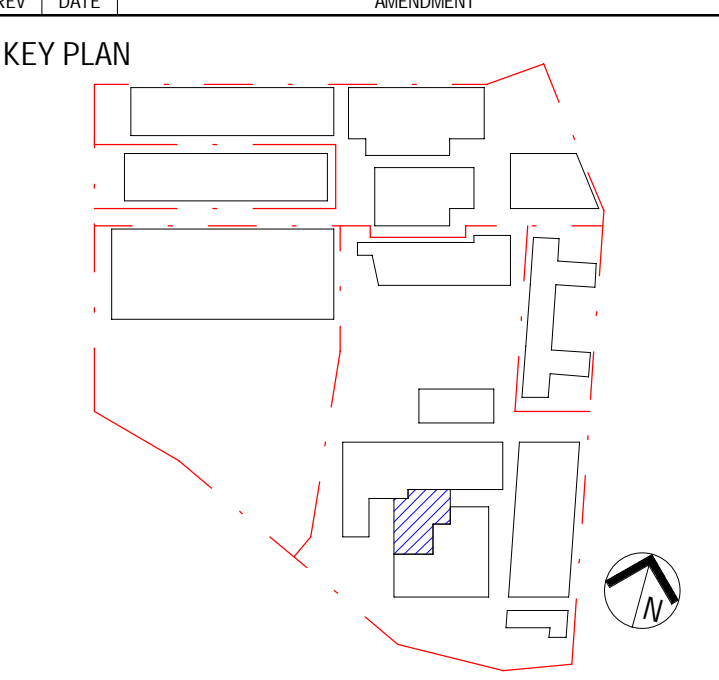

PROJECT MANAGER



CLIENT



ARCHITECT

**Jacobs**

Level 7, 177 Pacific Highway,  
North Sydney, NSW, 2060  
Tel: +61 2 9928 2100  
Fax: +61 2 9928 2510  
Web: jacobsgroup.com

PROJECT  
ROYAL PRINCE ALFRED HOSPITAL  
REDEVELOPMENT

PROJECT NO.  
1A0251300

DRAWING TITLE  
COVER SHEET - REF5

STATUS

**FOR INFORMATION**

DRAWN BL	DESIGNED DF
CHECKED RG	APPROVED CY

SCALE @ B1

DRAWING NO.  
RPA-ARC-JAC-DRG-REFS-000000

REVISION  
H

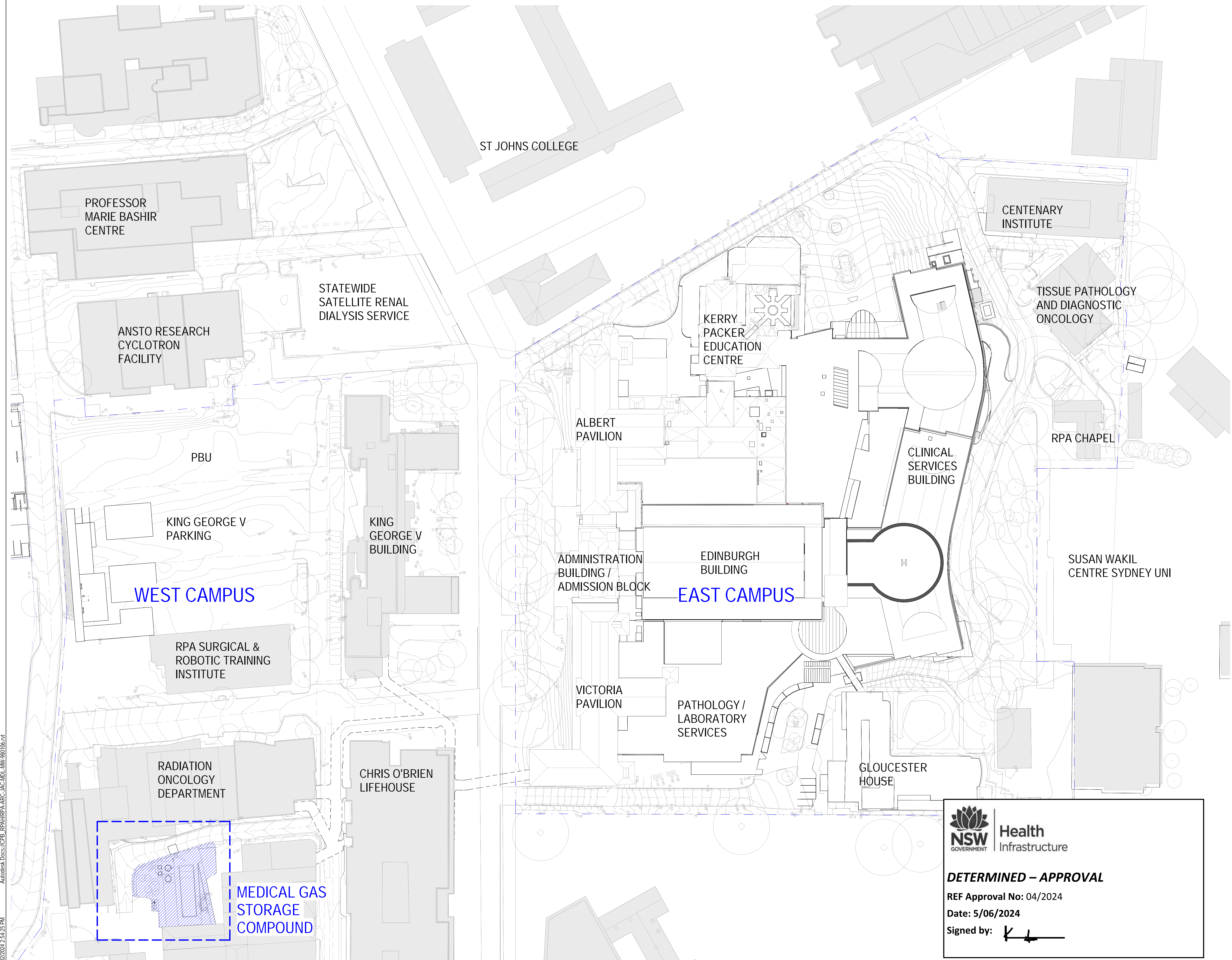

[illegible]





**REF Approval No: 04/2024**

**Date: 5/06/2024**

Signed by: 

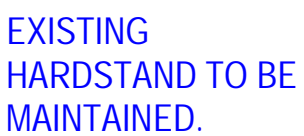

EXISTING FILL POINT

EXISTING 30KL  
PRIMARY AND  
SECONDARY TANK.

## EXISTING VAPORISERS .

EXISTING NITROGEN  
TANK.

EXISTING TREES.

EXISTING ROOF  
STRUCTURE.

## EXISTING TANK

EXISTING SHED.

### EXISTING RAMPS.

EXISTING ROAD

EXISTING ROOF  
STRUCTURE.

## LOADING ZONE

## NOTES

1. DO NOT SCALE DRAWINGS. WRITTEN DIMENSIONS GOVERN.

2. ALL DIMENSIONS ARE IN MILLIMETERS UNLESS NOTED OTHERWISE.

3. ALL DIMENSIONS SHALL BE TO FACE UNLESS SPECIFICALLY NOTED OTHERWISE.

4. JACOBS SHALL BE NOTIFIED IN WRITING OF ANY DISCREPANCIES.

5. THIS DRAWING MUST BE READ IN CONJUNCTION WITH ALL RELEVANT CONTRACTS, SPECIFICATIONS, REPORTS AND DRAWINGS.

6. ALL DRAWINGS TO BE PRINTED IN COLOUR, DO NOT PHOTO COPY - PRINT ORIGINAL FROM ELECTRONIC FILE FOR HARD COPY

7. VARIATIONS TO WORK SHOWN MUST BE PROPOSED TO THE PRINCIPALS ATTENTION AND BE APPROVED IN WRITING.

8. THIS DRAWING IS COPYRIGHT AND THE PROPERTY OF THE PRINCIPAL AND MUST NOT BE RETAINED, COPIED OR USED WITHOUT THE PERMISSION OF THE AUTHOR.

THIS DRAWING IS AN UNCONTROLLED COPY (UNLESS NOTED OTHERWISE)

9. THIS DRAWING IS NOT TO BE USED FOR CONSTRUCTION PURPOSES, IF A NOT AUTHORISED FOR CONSTRUCTION.

10. FOR CONSTRUCTION, ALL DIMENSIONS ARE PRELIMINARY IN NATURE & ARE TO BE VERIFIED ON SITE.

1902/24	ISSUED FOR SSDA
1808/23	REVISED REFS DRAFT ISSUE
0302/23	REFS FINAL ISSUE
27/01/23	REFS DRAFT ISSUE
18/01/23	REFS DRAFT ISSUE
17/01/23	REFS DRAFT ISSUE
18/11/22	REF7 DRAFT ISSUE
16/11/22	REF7 DRAFT ISSUE
04/11/22	AMENDMENT

## KEY PLAIN

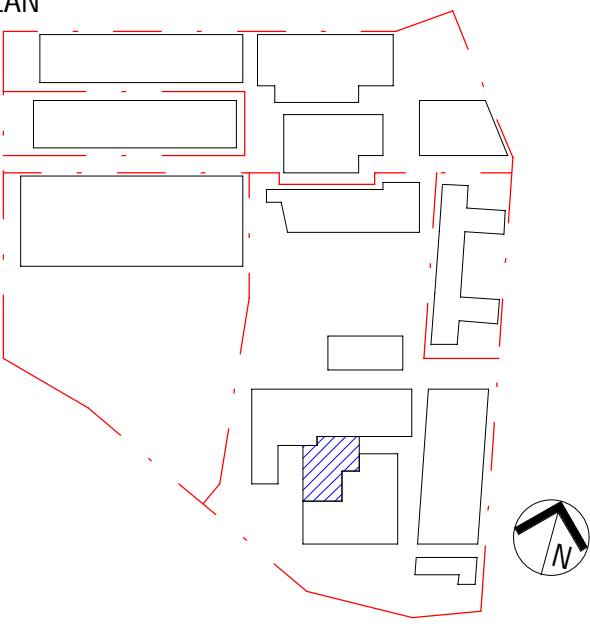

PROJECT MANAGER



CLIENT



ARCHITECT

# Jacobs.

Level 7, 177 Pacific Highway  
North Sydney, NSW, 2060  
Tel: +61 2 9928 2100  
Fax: +61 2 9928 2510  
Web: [jacobs.com](http://jacobs.com)

PROJECT  
ROYAL PRINCE ALFRED HOSPITAL  
REDEVELOPMENT

PROJECT NO.  
IA0251300

DRAWING TITLE  
EXISTING SITE PLAN - WESTERN CAMPUS -  
REF5

STATUS

FOR INFORMATION

DRAWN

DESIGNED

CHECKED

APPROVED

SCALE @ B1  
1 : 100

1 : 100

DRAWING NO.  
RPA-ARC-JAC-DRG-REF5-000002

REVISION

H



REF5 - WORKS SUMMARY

- 1 NEW VAPORISERS.
- 2 NEW 30KL PRIMARY TANK.
- 3 NEW NATURAL FINISH RC SLAB.
- 4 FIRE RATED WALLS TO BE PROVIDED FOR FIRE RATED REQUIREMENT.
- 5 NEW RAMP.
- 6 NEW SECURITY FENCING & ACCESS GATE TO NEW STORE AREA.
- 7 NEW LANDING FLUSH WITH EXISTING STORAGE LEVEL.
- 8 NEW FLAMMABLE GAS CYLINDER STORAGE BAYS.



DETERMINED – APPROVAL

REF Approval No: 04/2024

Date: 5/06/2024

Signed by:

NON INPATIENT UNIT AREA  
TO BE INVESTIGATED BY  
CONTRACTORS.

ROCHESTER STREET

EXISTING HARDSTAND TO BE  
MAINTAINED. INSTALL NEW FILL  
POINT FOR NEW VESSEL AT  
SAME LOCATION.

REF5-400001.D-2

1 NEW VAPORISERS IN  
ACCORDANCE WITH  
MECHANICAL ENGINEERS  
DETAILS.

NON INPATIENT UNIT AREA TO  
BE INVESTIGATED BY  
CONTRACTORS.

6 NEW SECURITY FENCING  
& ACCESS GATE.

2 NEW 30KL VESSEL TANK IN  
ACCORDANCE WITH  
MECHANICAL ENGINEERS  
DETAILS. SUPPLY OF TANK AND  
VAPORISERS AND ASSOCIATED  
ITEM BY CORE GAS UNDER  
ARRANGEMENT WITH SLHD CIE.

3 NEW R.C. SLAB WITH FLUSH TO  
EXISTING SURROUNDING SLAB  
AREAS IN ACCORDANCE WITH  
STRUCTURAL ENGINEERING  
DETAILS.

4 240/240/240 FIRE RATED  
NATURAL FINISH BLOCKWORK  
WALLS IN ACCORDANCE WITH  
STRUCTURAL ENGINEERS  
DETAILS.

6 NEW SECURITY FENCING.

5 NEW RAMP IN ACCORDANCE WITH  
STRUCTURAL ENGINEERS DETAILS.

7 NEW LANDING FLUSH WITH  
EXISTING STORAGE LEVEL IN  
ACCORDANCE WITH STRUCTURAL  
ENGINEERS DETAILS.

8 FLAMMABLE MAJOR STORE 500L  
PLUS.

6 NEW SECURITY ACCESS GATE.

4 240/240/240 FIRE RATED  
NATURAL FINISH BLOCKWORK  
WALLS IN ACCORDANCE WITH  
STRUCTURAL ENGINEERS  
DETAILS.

LOADING ZONE

NOTES

1. DO NOT SCALE DRAWINGS. WRITTEN DIMENSIONS GOVERN.
2. ALL DIMENSIONS ARE IN MILLIMETRES UNLESS NOTED OTHERWISE.
3. ALL DIMENSIONS SHALL BE VERIFIED ON SITE BEFORE PROCEEDING WITH THE WORK.
4. THIS DRAWING MUST BE READ IN CONJUNCTION WITH ALL RELEVANT CONTRACTS, SPECIFICATIONS, REPORTS AND DRAWINGS.
5. ALL DRAWINGS TO BE PRINTED IN COLOUR. DO NOT PHOTOCOPY - PRINT ORIGINAL FROM ELECTRONIC FILE FOR HARD COPY.
6. VARIATIONS TO WORK SHOWN MUST BE BROUGHT TO THE PRINCIPALS ATTENTION AND APPROVED IN WRITING BEFORE PROCEEDING.
7. THIS DRAWING IS COPYRIGHT AND THE PROPERTY OF THE PRINCIPAL AND MUST NOT BE RETAINED, COPIED OR USED WITHOUT THE PERMISSION OF THE AUTHOR.
8. THIS DRAWING IS FOR REF APPLICATION PURPOSES ONLY & IS NOT AUTHORISED FOR USED FOR CONSTRUCTION. ALL DIMENSIONS ARE PRELIMINARY IN NATURE & ARE TO BE VERIFIED ON SITE.

LEGEND

- BUILDING/ STRUCTURE RE-CONFIGURATION  
REFER RELEVANT SERVICES DRAWINGS
- EXISTING GAS MANIFOLD
- DEMOLITION

REV	DATE	AMENDMENT
I	19/02/24	ISSUED FOR ISSA
H	18/08/23	REVISED REF5 DRAFT ISSUE
G	03/02/23	REFS FINAL ISSUE
F	27/01/23	REFS DRAFT ISSUE
E	18/01/23	REFS DRAFT ISSUE
D	17/01/23	REFS DRAFT ISSUE
C	23/11/22	REF DRAFT ISSUE
B	18/11/22	REF DRAFT ISSUE
A	16/11/22	REF DRAFT ISSUE

KEY PLAN

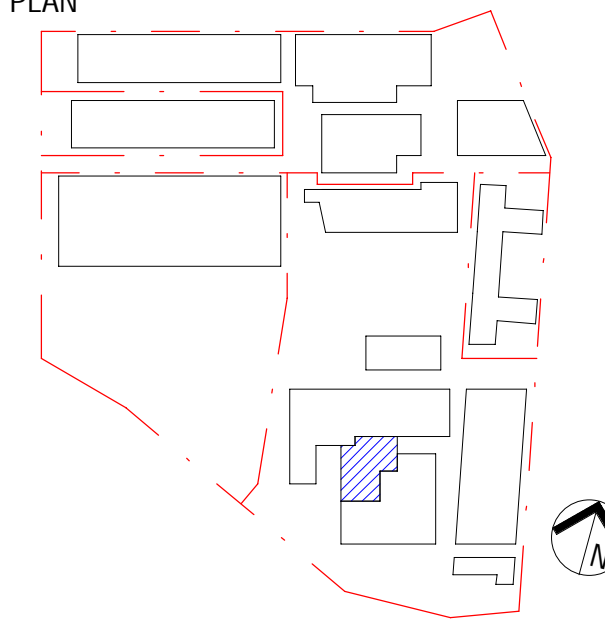

PROJECT MANAGER

TSA

CLIENT



ARCHITECT

Jacobs

Level 7, 177 Pacific Highway,  
North Sydney, NSW, 2060  
Tel: +61 2 9928 2100  
Fax: +61 2 9928 2110  
Web: jacobsgroup.com

PROJECT  
ROYAL PRINCE ALFRED HOSPITAL  
REDEVELOPMENT

PROJECT NO.  
IA0251300

DRAWING TITLE  
PROPOSED LEVEL 1 PLAN - WESTERN CAMPUS  
- REF 5

STATUS

FOR INFORMATION

DRAWN BL DESIGNED DF

CHECKED RG APPROVED CY

SCALE @ B1  
1 : 100

DRAWING NO.  
RPA-ARC-JAC-DRG-REF5-000003

REVISION  
1



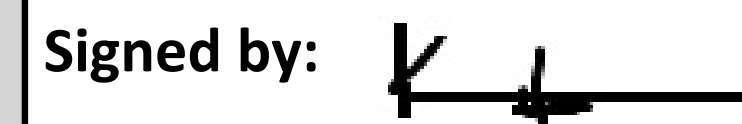

- 1 NEW VAPORISERS.
- 2 NEW 30kL PRIMARY TANK.
- 3 NEW NATURAL FINISH RC SLAB.
- 4 FIRE RATED WALLS TO BE PROVIDED FOR FIRE RATED REQUIREMENT.
- 5 NEW RAMP.
- 6 NEW SECURITY FENCING & ACCESS GATE TO NEW STORE AREA.
- 7 NEW LANDING FLUSH WITH EXISTING STORAGE LEVEL.
- 8 NEW FLAMMABLE GAS CYLINDER STORAGE BAYS.



LOADING ZONE

DO NOT SCALE DRAWINGS. WRITTEN DIMENSIONS GOVERN.  
ALL DIMENSIONS ARE IN MILLIMETERS UNLESS NOTED OTHERWISE.  
ALL DIMENSIONS SHALL BE VERIFIED ON SITE BEFORE PROCEEDING WITH THE WORK.  
DIMENSIONS SHALL BE NOTED ON ANY PHOTOGRAPHY.  
THIS DRAWING MUST BE READ IN CONJUNCTION WITH ALL RELEVANT CONTRACTS,  
SPECIFICATIONS, REPORTS AND DRAWINGS.  
ALL DRAWINGS TO BE PRINTED IN COLOUR. DO NOT PHOTOCOPY - PRINT ORIGINAL FROM  
ELECTRONIC FILE FOR HARD COPY.  
VARIATIONS TO WORK SHOWN MUST BE BROUGHT TO THE PRINCIPALS ATTENTION AND  
APPROVED IN WRITING BEFORE PROCEEDING.  
THIS DRAWING IS THE PROPERTY OF THE PRINCIPAL AND MUST NOT BE  
REPRODUCED, COPIED OR USED WITHOUT THE PERMISSION OF THE AUTHOR.  
THIS DRAWING IS AN UNCONTROLLED COPY UNLESS NOTED OTHERWISE.  
THIS DRAWING IS NOT TO BE USED FOR CONSTRUCTION. ALL DIMENSIONS ARE PRESUMED IN NATURE & ARE TO BE VERIFIED  
ON SITE.

-  - BUILDING/ STRUCTURE RE-CONFIGURATION  
*REFER RELEVANT SERVICES DRAWINGS*
-  - EXISTING GAS MANIFOLD
-  - DEMOLITION

REV	DATE	AMENDMENT
	180224	ISSUED FOR SSDA
	180823	REVISED REFS DRAFT ISSUE
	030923	REFS FINAL ISSUE
	270923	REFS DRAFT ISSUE
	180923	REFS DRAFT ISSUE
	170923	REFS DRAFT ISSUE
	230922	REF7 DRAFT ISSUE
	181022	REF7 DRAFT ISSUE
	181022	REF7 DRAFT ISSUE
	181022	REF7 DRAFT ISSUE

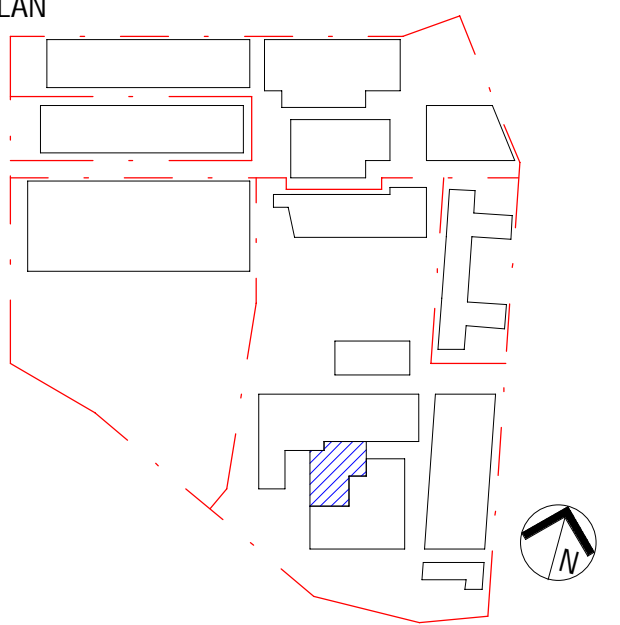
**TSA**

**Health**  
Sydney  
Local Health District



**Health**  
Infrastructure

**Jacobs.**

Level 7, 177 Pacific Highway,  
North Sydney, NSW, 2060  
Tel: +61 2 9928 2100  
Fax: +61 2 9928 2510  
Web: [jacobs.com](http://jacobs.com)

PROJECT  
ROYAL PRINCE ALFRED HOSPITAL  
REDEVELOPMENT

PROJECT NO.  
IA0251300

DRAWING TITLE  
PROPOSED ROOF PLAN - WESTERN CAMPUS -  
REF5

STATUS

FOR INFORMATION

DRAWN BL	DESIGNED DF
-------------	----------------

CHECKED RG	APPROVED CY
---------------	----------------

SCALE @ B1  
1 : 100

DRAWING NO.  
RPA-ARC-JAC-DRG-REF5-000004

REVISION





**DETERMINED – APPROVAL**

REF Approval No: 04/2024

Date: 5/06/2024

Signed by: 

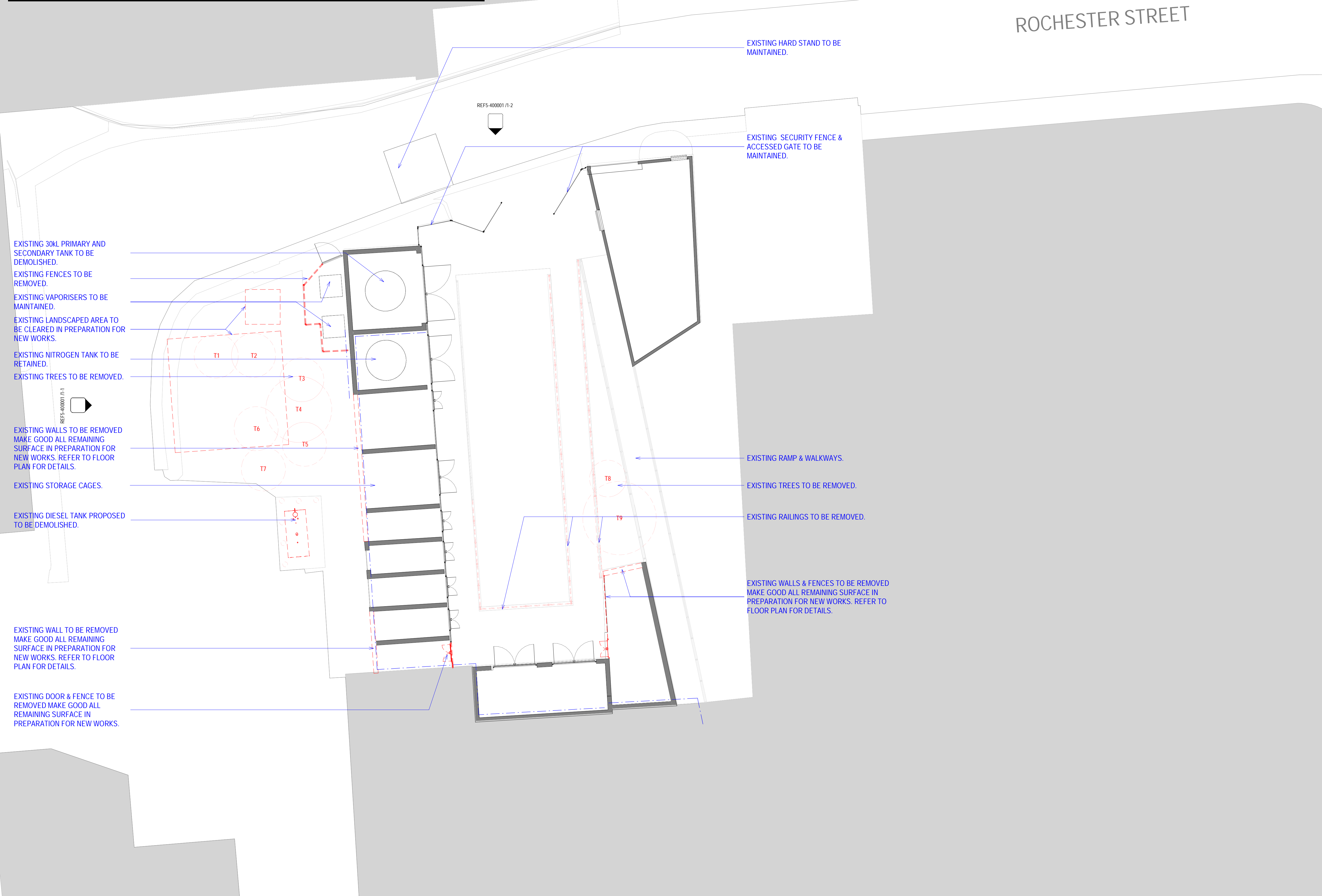

**NOTES**

1. DO NOT SCALE DRAWINGS. WRITTEN DIMENSIONS GOVERN.  
2. ALL DIMENSIONS ARE IN MILLIMETRES UNLESS NOTED OTHERWISE.  
3. ALL DIMENSIONS SHALL BE VERIFIED ON SITE BEFORE PROCEEDING WITH THE WORK.  
4. THIS DRAWING MUST BE READ IN CONJUNCTION WITH ALL RELEVANT CONTRACTS, SPECIFICATIONS, REPORTS AND DRAWINGS.  
5. ALL DRAWINGS TO BE PRINTED IN COLOUR. DO NOT PHOTOCOPY - PRINT ORIGINAL FROM ELECTRONIC FILE FOR HARD COPY.  
6. VARIATIONS TO WORK SHOWN MUST BE BROUGHT TO THE PRINCIPALS ATTENTION AND APPROVED IN WRITING BEFORE PROCEEDING.  
7. THIS DRAWING IS COPYRIGHT AND THE PROPERTY OF THE PRINCIPAL AND MUST NOT BE RETAINED, COPIED OR USED WITHOUT THE PERMISSION OF THE AUTHOR.  
8. THIS DRAWING IS FOR REF APPLICATION PURPOSES ONLY & IS NOT AUTHORISED FOR USE FOR CONSTRUCTION. ALL DIMENSIONS ARE PRELIMINARY IN NATURE & ARE TO BE VERIFIED ON SITE.

**LEGEND**

 - BUILDING/ STRUCTURE RE-CONFIGURATION  
REFER RELEVANT SERVICES DRAWINGS

 - EXISTING GAS MANIFOLD

 - DEMOLITION

REV	DATE	AMENDMENT
H	19/02/2024	ISSUED FOR SSDA
G	18/08/23	REVISED REFS DRAFT ISSUE
F	10/08/23	REFS FINAL ISSUE
E	27/07/23	REFS DRAFT ISSUE
D	17/07/23	REFS DRAFT ISSUE
C	23/11/22	REF DRAFT ISSUE
B	18/11/22	REF DRAFT ISSUE
A	16/11/22	REF DRAFT ISSUE

**KEY PLAN**



**PROJECT MANAGER**



**CLIENT**



**ARCHITECT**



Level 7, 177 Pacific Highway,  
North Sydney, NSW, 2060  
Tel: +61 2 9028 2100  
Fax: +61 2 9028 2510  
Web: jacobsgroup.com

**PROJECT**

ROYAL PRINCE ALFRED HOSPITAL  
REDEVELOPMENT

**PROJECT NO.**

1A0251300

**DRAWING TITLE**

DEMOLITION PLAN - WESTERN CAMPUS - REF5

**STATUS**

**FOR INFORMATION**

DRAWN BL	DESIGNED DF
CHECKED RG	APPROVED CY

**SCALE @ B1**

1 : 100

DRAWING NO. RPA-ARC-JAC-DRG-REF5-180001	REVISION H
--	---------------



- 1 NEW VAPORISERS.
- 2 NEW 30KL PRIMARY TANK.
- 3 NEW NATURAL FINISH RC SLAB.
- 4 FIRE RATED WALLS TO BE PROVIDED FOR FIRE RATED REQUIREMENT.
- 5 NEW RAMP.
- 6 NEW SECURITY FENCING & ACCESS GATE TO NEW STORE AREA.
- 7 NEW LANDING FLUSH WITH EXISTING STORAGE LEVEL.
- 8 NEW FLAMMABLE GAS CYLINDER STORAGE BAYS.



- DEMOLITION

## REVISION

